

**General Description**

Rigpro Hoists, the ultimate choice for stage productions, are engineered for the entertainment industry, these electric chain hoists provide reliable setups and installation for speakers, lighting systems, stage sets, and more. With exceptional features and continuous adaptability, Rigpro hoists are trusted and have a global presence.

RC-250LV, the chain hoist with 250 kg load capacity, is design and made according to D8 plus principle. It is equipped with two independent DC brakes, main brake and secondary brake. The brakes act immediately in case of power disconnection or failure so that the load is held safely. RC-250LV is fitted with a friction clutch to protect the drive. Integrated with magnetic positioning switch which provides contactless travel limit setting. It is equipped with high-strength steel load chain according to EN818-7.

The robust and sturdy housing is fabricated by aluminum alloy and treated with a matt black paints. It is also available in other colors. It is a three-phase direct voltage control chain hoist. The standard operation voltage is 400V, 3-phase, 50Hz. Other operating voltage is available.



<b>Model number</b>	RC-250LV
<b>Speed</b>	4 M/min (50Hz)
<b>Version</b>	Low Voltage Control

**Contents**

1. General Description ..... 1  
2. Technical Data .....2  
3. Dimension Sheet .....3

- Specifications subject to change without notice.
- [www.stage.com.tw](http://www.stage.com.tw)

**PRODUCT DATA SHEET**

**Features**

- \* Die casting aluminum chassis; sturdy and durable
- \* Black epoxy powder paints finish; matt outlook and low key
- \* Aluminum chain leading guide eliminates the chain jamming
- \* Two spring-loaded heavy-duty DC brakes; requiring very little maintenance
- \* Drop-forged high tensile steel hook; ensuring proper rigging load
- \* 25% ED duty cycle motor; robust and high efficiency
- \* Operated on standard 3-phase voltage 400V 50Hz
- \* Comform to ISO (1Bm) and FEM (M3) classification
- \* Average operation noise within 65db; quiet and less noisy
- \* Chain bag with durable textile
- \* Magnetic positioning switch provides contactless and convenient travel limit setup

**Mechanical**

- Friction clutch for overload protection
- Operating coefficient load chain - 8 (static)
- 3m cable with 4pin CEE (red) connector (power)
- 3m cable with 4pin CEE (yellow) connector (control)
- Precise chain guide with 5-pocket chain sprocket wheel
- Up and down POM blocks build in ring magnet for activating magnetic switch positioning
- 1-fall load hook
- Upright and climbing operation
- 360 degree turnable hook suspension

**Electrical**

motor power:	0.2 kW	rated current:	400V: 0.9 A
power factor cos φ:	0.43		220V: 1.8 A
nominal voltage:	3ph 400V	degree of protection:	IP 20
frequency:	50Hz	control equipment:	low voltage control

**Technical**

model type:	RC-250LV
hoisting speed:	4.0 M/min (50Hz); 4.8 M/min (60Hz)
safe working load:	250kg
number of falls:	1
load chain according to EN 818-7:	4.0 x 12 mm
suspension type:	360 degree turnable hook suspension
classification of mechanism lifting gear	FEM/ ISO
	1Bm / M3
duty cycle - starts per hour:	ED 25% - 150 cycle per hour
noise level:	65 dB(A)/ 1 m distance
weight (without chain):	approx. 11 kg
weight of the chain:	approx. 0.35 kg/m

- Specifications subject to change without notice.
- [www.stage.com.tw](http://www.stage.com.tw)

**CHAIN HOIST 250 KG ACCORDING TO IGWV SQP2 (D8 PLUS)**  
**PRODUCT DATA SHEET**

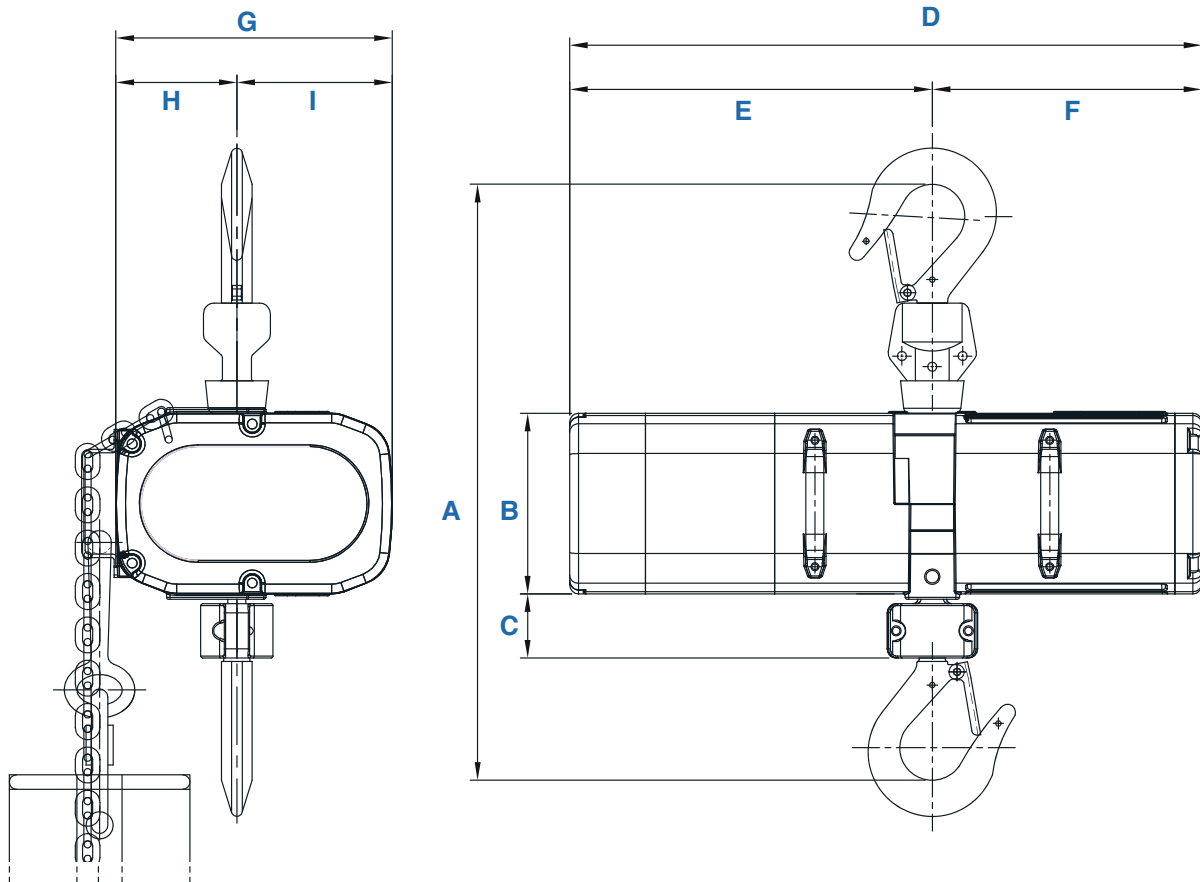

unit: mm

Model	A	B	C	D	E	F	G	H	I
RC-250LV	350	100	35.5	350	200	150	153	67	86

- Specifications subject to change without notice.
- [www.stage.com.tw](http://www.stage.com.tw)

